

*"When we build  
Let us think that we build forever  
Let it not be for the present delight  
Nor for the present use alone  
Let it be such work as our descendents will thank us forever."*

*-John Ruskin-*



**Manqaldeep Palbala ji**







## ★ STAR FACILITIES ★

- Every room fitted with air-conditioners of reputed brands
- LCD TV adorn the walls of each apartment
- A well equipped ready to use modular kitchen
- Free car parking for each flat
- State of the Art Designer Community Hall, Health Club, State of the Art Gymnasium and Amphitheatre

## AMENITIES

- Grand and articulate entrance lobby.
- Flats that are open on all sides.
- Marble/granite/vitrified flooring in all rooms.
- Every room along with the hall has spacious balconies.
- Walls painted in warm tones.
- POP false ceiling with decorative lights.
- Designer glazed tiles up to dado in all bath areas.
- Modern modular kitchen.
- Water purifier of a reputed company.
- Geyser in bathrooms and the kitchen as well.
- Ceiling fans in all rooms with exhaust fans in kitchen and bath areas.
- Ceramic tiles for added protection up to 2 ft height in kitchen.
- Dedicated cable TV line in all rooms.
- Large and beautiful french sliding windows with tinted glass and auto lock.
- Main entrance door made of solid teakwood.
- ISI marked fittings in electric, sanitary and plumbing facilities.
- Two hi speed elevators of reputed brand with power back up in each wing.
- Individual car parking for every apartment.
- Beautiful, landscaped garden flanked by a gym, health club, tennis court and multipurpose court in the building compound.
- Amphitheatre.
- Children's play area
- Total power back-up for all utilities
- CCTV intercom system in the entire complex.
- Earthquake resistant structure.
- Concealed copper wiring with circuit breakers. TV cable and telephone points in the living room and the bedrooms.
- Adequate electrical points complimented by premium switches.
- Modern fire fighting systems.
- Attractive and secure entrance gate.







# super built up area

**FLAT NO.**

**TYPE**

**AREA**

## Wing A

01.....	3BHK.....	1650 SQ. FT.
02 .....	2&1/2BHK.....	1403 SQ. FT.
03.....	3BHK.....	1790 SQ. FT.
04.....	2BHK.....	1368 SQ. FT.
05.....	2BHK.....	1422 SQ. FT.
06.....	3BHK.....	1770 SQ. FT.

## Wing B

01.....	2BHK.....	1250 SQ. FT.
02.....	2BHK.....	1298 SQ. FT.
03.....	2BHK.....	1250 SQ. FT.
04.....	2BHK.....	1277 SQ. FT.

## Wing C

01.....	2BHK.....	1262 SQ. FT.
02.....	3BHK.....	1658 SQ. FT.
03.....	2BHK.....	1237 SQ. FT.

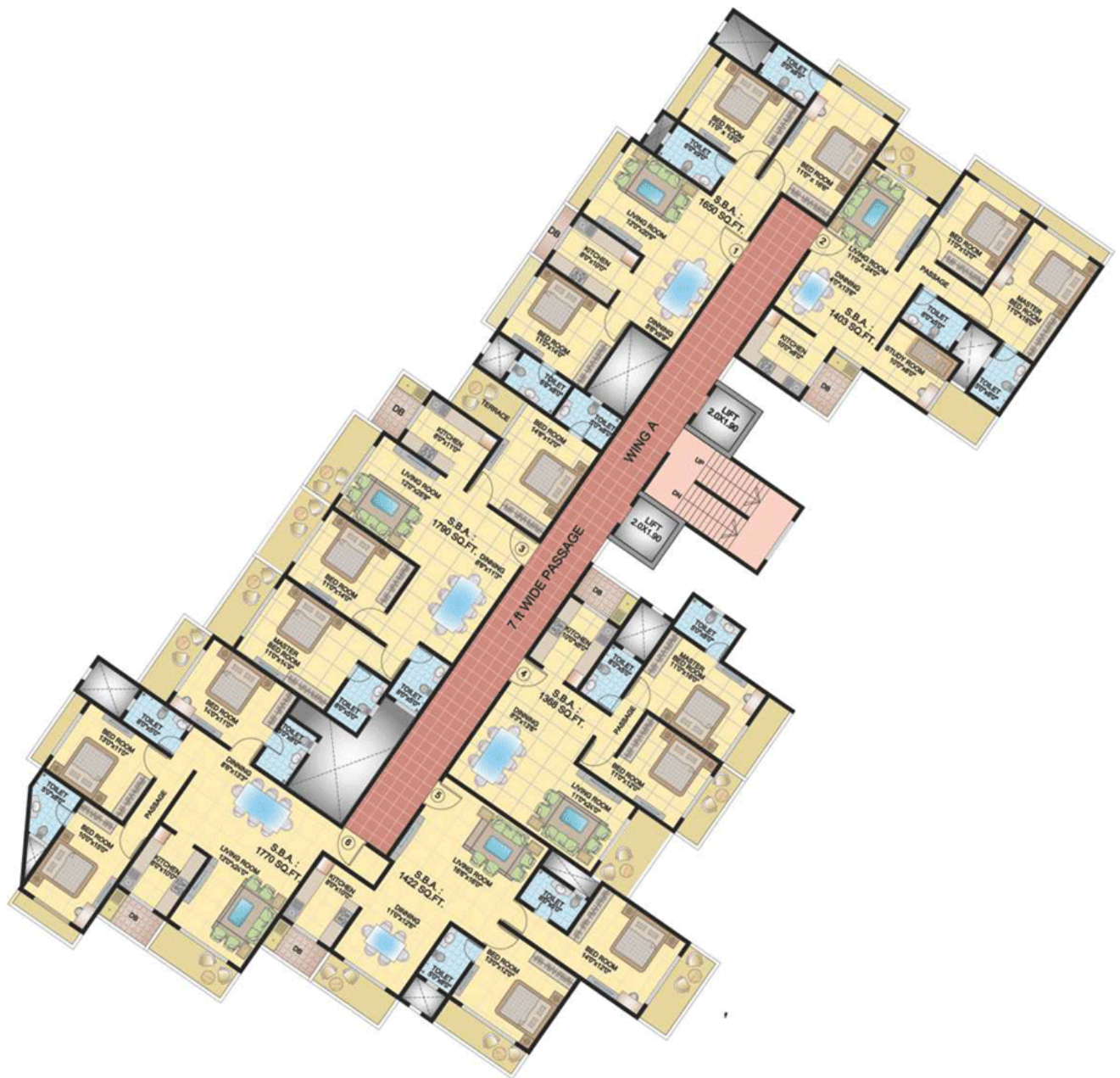

TYPICAL FLOOR PLAN OF WING 'A'





TYPICAL FLOOR PLAN OF WING 'B'

Wing BImage 2 of 4  
CLOSE X



TYPICAL FLOOR PLAN OF WING 'C'

Wing C Image 3 of 4  
CLOSE X



Developers



**Mangaldeep Palbalaji**  
JODHPUR

**OWNER & DEVELOPERS:**

**M/s. MANGALDEEP PALBALAJI**

**OFFICE & SITE ADDRESS:**

Near Latiyal Vatika, Main Pal Road, Jodhpur - 342003.

Telefax: 0291-2435003

E-mail: mangaldeepjodhpur@gmail.com Website: www.mangaldeepjodhpur.com

**CONTACT PERSON:**

**Mr. R.S. Lodha** +91 94141 07099 / +91 93517 66361 (Jodhpur)

**Dr. Kiran Choudhary** +91 94144 71679 (Jodhpur)

**Mr. Atul Bhansali** +91 98205 21222 (Mumbai)

**ARCHITECT:**

**SKYLINE ARCHITECTS**

Mumbai

**ENGINEERS & RCC CONSULTANT:**

**M/S U.D.CHANDE**

Consulting Engineer Mumbai

**FINANCE APPROVED BY MAJOR BANKS**

**Disclaimer:** The information and photographs contained herein are subject to change and cannot form an offer or contract. While every reasonable care has been taken in providing the information, the owner or his agents cannot be held responsible for any inaccuracies. The promoters reserve their rights to make alterations, additions and amendments as may be necessary and from time to time without any notice. All dimensions are structural profile dimensions. Mangaldeep Palbalaji Jodhpur. All drawings and images are computer generated.